



Gold Cloud Productivity
Gold Small and Midmarket Cloud Solutions
Silver Cloud Platform

SUPERHUB HOSTED EXCHANGE 2013 ANDROID ACTIVESYNC SETUP GUIDE

Table of Contents

1. Configuration.....	3
2. Get Help and Support.....	5

The guide is an Android ActiveSync Configuration Guide for Hosted Exchange 2013.

However, various Android versions may have different screen prompts and the layouts below are for your reference only. The general step should still hold.

1. Configuration

Step 1:

Open **Email** app in your android. Select **Menu and Setting**.
Select **Mail**. Select **Add Account**.

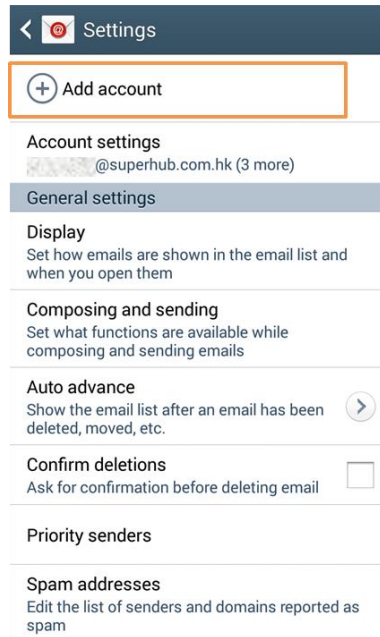

Step 2:

Enter your username and password. Click **Manual Setup**.

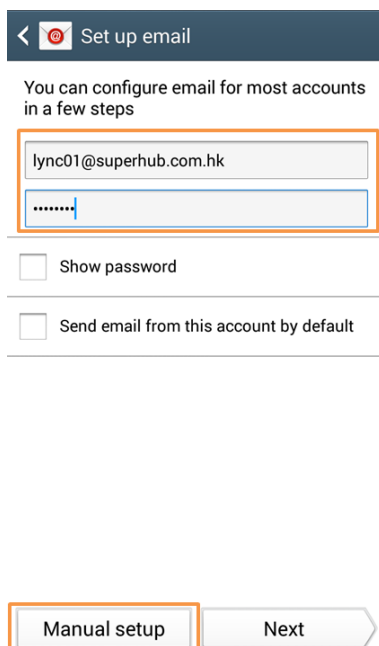

Step 3:
Select Microsoft **Exchange ActiveSync** (or **Exchange** in some devices).

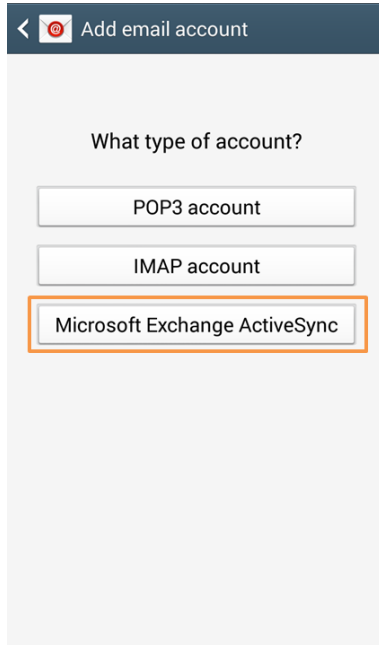

Step 4:
Confirm the account options such as sync **Contacts**, **Calendar** and **Email**. Click **Next**.

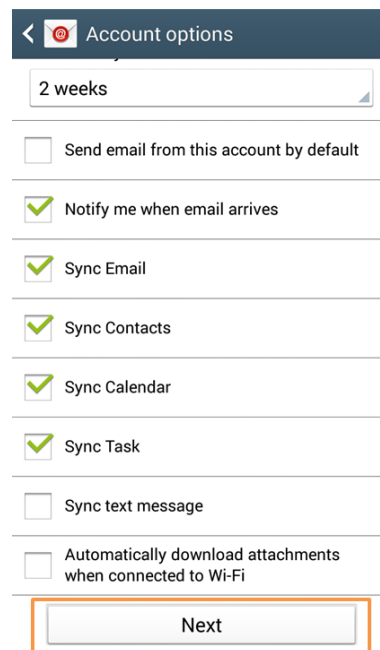
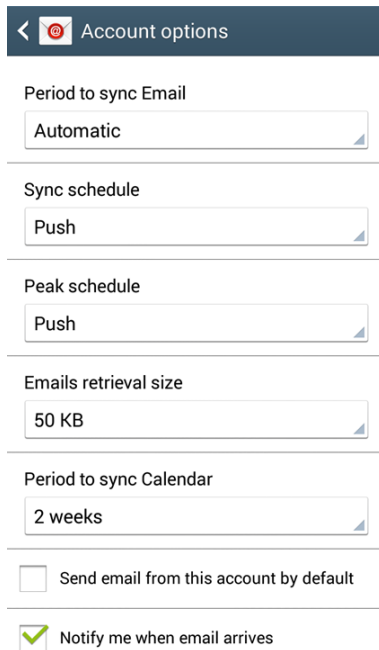

Step 5:

An ActiveSync account is setup in your android device successfully. Click **Next** to start.

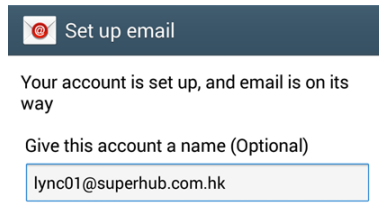

Set up email

Your account is set up, and email is on its way

Give this account a name (Optional)

lync01@superhub.com.hk

Done

2. Get Help and Support

We are glad to assist you with any enquiry or issue on the setup and use of service. Please contact our Support team via email support@superhub.com.hk or via phone at +852 2353-1445.